

# B600003



- ▶ 主要技术特性 (Main Specifications)
- ▶ 适用导线规格 (Applicable wire) : AWG20#~12#
- ▶ 适用基板厚度 (Applicable PC board thickness) : —
- ▶ 温度范围 (Temperature range) : -25°C~+85°C
- ▶ 额定电压 (Voltage rating) : 300V AC, DC
- ▶ 额定电流 (Current rating) : 5A AC, DC
- ▶ 接触电阻 (Contact resistance) :  $\leq 0.02\Omega$
- ▶ 绝缘电阻 (Insulation resistance) :  $\geq 1000M\Omega$
- ▶ 耐压 (Withstanding voltage) : 1500V AC/minute

## 材料及电镀规格 Material and Finish

型号 Type	材料 Material	材料厚度 Material Thickness	电镀规格 Finish
孔座 HOUSING	PA66 UL94V-0	—	N/A
端子 TERMINAL	锡青铜 Phosphor bronze	0.3mm	镀锡 Tin-plated

## 产品尺寸图 Product size chart

 单位: mm 一般公差:  $\pm 0.20$ 

### TERMINAL

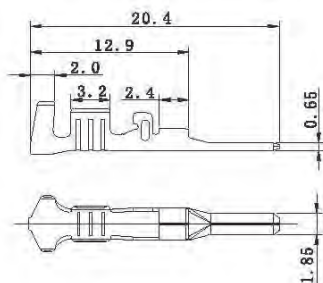
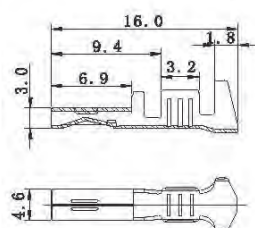
**B600003-3**
**ST740465-3**

**B600003-4**
**ST730461-3**

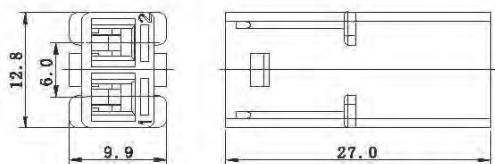
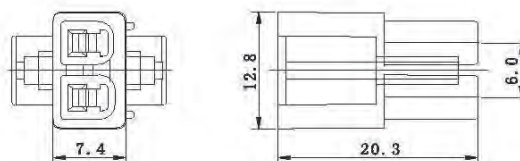
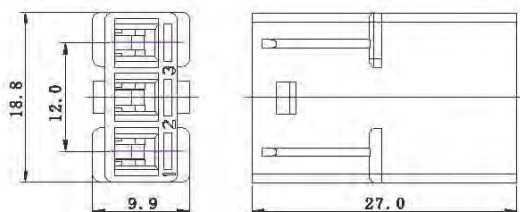
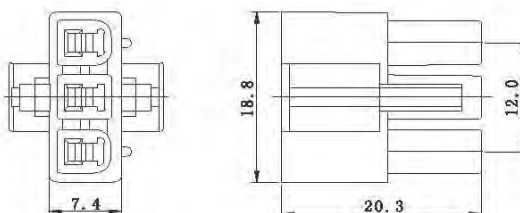
### HOUSING

**B600003-1-02**
**MG620426**

**B600003-2-02**
**MG610224**

**B600003-1-03**
**MG620427**

**B600003-2-03**
**MG610226**

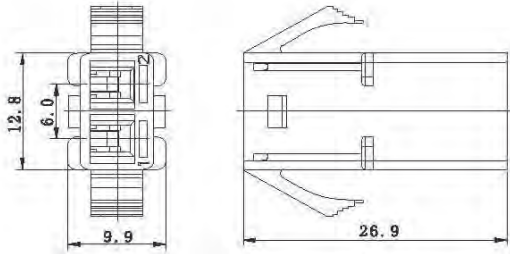
# B600003

## HOUSING

**B600003-1-02A** **MG620225**



**B600003-1-04** **MG620429**

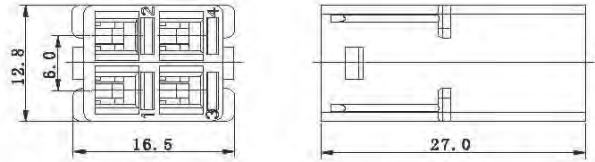

**B600003-1-03A** **MG620427-S**

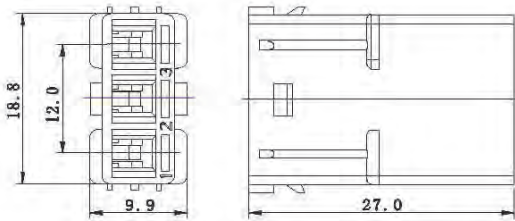

**B600003-2-03A** **MG610226-S**

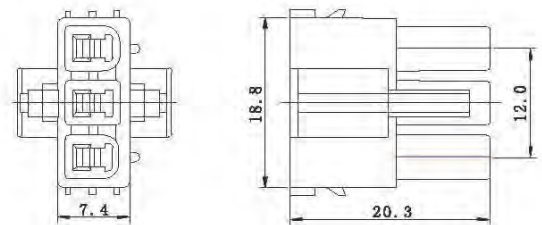

**B600003-1-04A** **MG620429-S**

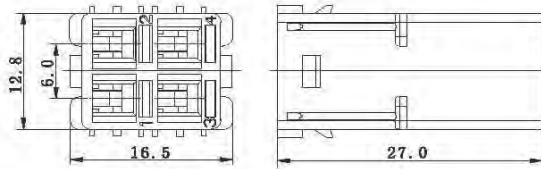

**B600003-2-04A** **MG610228-S**

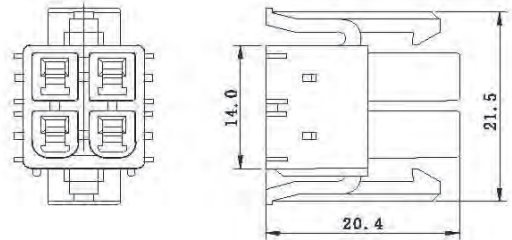

**B600003-5-02A** **MG610228** 止档片

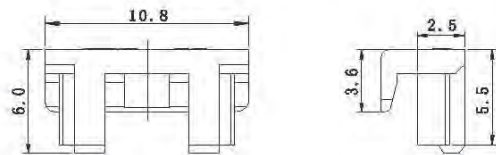

**B600003-5-02B** **MG610228** 锁定片

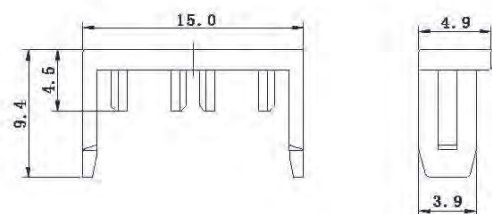

**B600003-5-03B** **MG610226** 锁定片

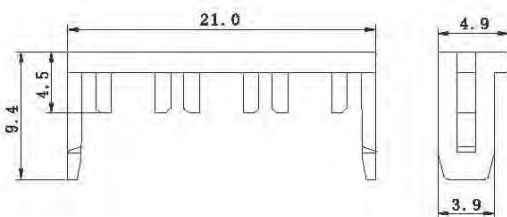

# B600003

## TERMINAL

B600003-3-I LY-1.8K1-ART

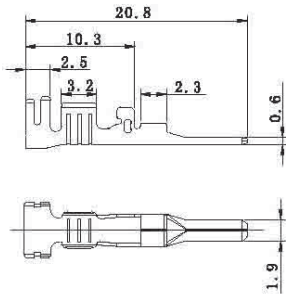

B600003-4-I LZ-1.8K1-BRT

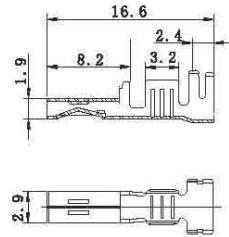

## HOUSING

B600003-1-04B MG620229 LZY-1.8K-4Y

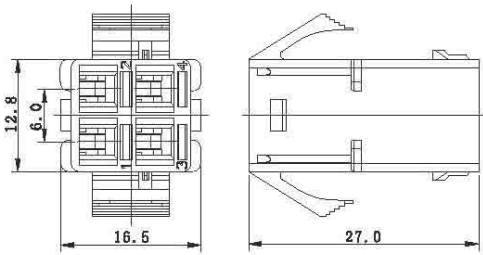

B600003-2-04 MG610228 LZY-1.8K-4

